

SHAFT SPACERS

TYPE	SHAFT SIZE	MATERIALS
INNER RACE SHAFT	1/4 TO 1/2	18-8 STAINLESS STEEL OR ANODIZED ALUMINUM

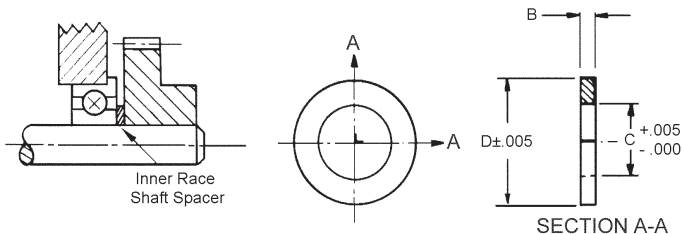

STAINLESS STOCK NO.	ALUMINUM STOCK NO.	C	D	B	
SS2-66				.002	
SS2-27	-			.004	±.001
SS2-28	-			.006	
SS2-60	-			.008	
SS2-29	-			.010	
SS2-61	-			.012	±.002
SS2-62	-			.014	
SS2-30	-	.250	.375	.016	
SS2-31	SS2-31-A			.031	
SS2-32	SS2-32-A			.063	
SS2-63	SS2-63-A			.094	
SS2-33	SS2-33-A			.125	
SS2-64	SS2-64-A			.188	
SS2-34	SS2-34-A			.250	±.003
SS2-65	SS2-65-A			.375	
SS2-35	SS2-35-A			.500	
SS2-80	-			.002	
SS2-81	-			.004	±.001
SS2-82	-			.006	
SS2-83	-			.008	
SS2-36	-			.010	
SS2-84	-	.313	.500	.012	±.002
SS2-85	-			.014	
SS2-37	-			.016	
SS2-38	-			.031	
SS2-39	-			.062	±.003
SS2-40	-			.125	

STAINLESS STOCK NO.	ALUMINUM STOCK NO.	C	D	B	
SS2-67	-			.002	
SS2-68	-			.004	±.001
SS2-69	-			.006	
SS2-70	-			.008	
SS2-41	-			.010	
SS2-71	-			.012	±.002
SS2-72	-			.014	
SS2-42	-	.375	.562	.016	
SS2-43	SS2-43-A			.031	
SS2-44	SS2-44-A			.063	
SS2-73	SS2-73-A			.094	
SS2-45	SS2-45-A			.125	
SS2-74	SS2-74-A			.188	±.003
SS2-75	SS2-75-A			.250	
SS2-76	SS2-76-A			.375	
SS2-77	SS2-77-A			.500	
SS2-90	-			.002	
SS2-91	-			.004	±.001
SS2-92	-			.006	
SS2-93	-			.008	
SS2-46	-			.010	
SS2-94	-	.500	.750	.012	±.002
SS2-95	-			.014	
SS2-47	-			.016	
SS2-48	-			.031	
SS2-49	-			.062	±.003
SS2-50	-			.125	

Sold in packages of 10.

Also available

STOCK NO.	DESCRIPTION OF KIT
KIT-SS1	STAINLESS STEEL SHAFT SPACERS, INNER RACE, 1/8, 3/16 AND 1/4" SHAFT SIZES (330 PIECES)